

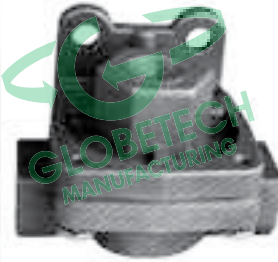

Quick Release Valves



Overall height: 2-1/2"
 Overall width: 3-1/4"
 Delivery ports: (2) 3/8" PT
 Supply ports: GTA-229859 (1) 3/8"
 GTA-229860 (1) 1/2"
 Crack Pressure: 1 PSI
 Mounting holes: 11/32" dia., 1-1/2" C-C
 Replaces: Bendix 229859 (QR-1A)
 Bendix 229860 (QR-1B)

Part Number	Description
GTA-229859	Quick release valve
GTA-229860	Quick release valve



Overall height: 2-11/16"
 Delivery ports: GTA-289714 (2) 3/8" PT
 GTA-289182 (2) 1/4" PT
 Supply ports: (1) 1/4" PT
 Balance: (1) 1/4" PT
 Mounting holes: 11/32" dia., 1-1/2" C-C
 Replaces: Bendix 289714 (QR-1C)
 Bendix 289182 (QR-1C)

Part Number	Description
GTA-289714	Quick release valve
GTA-289182	Quick release valve

Relay Valves



Body height: 3-7/8"
 Delivery ports: (4) GTA-065104 = 3/8" PT
 GTA-102626 = 1/2" PT
 Supply ports: (1) 1/2" PT
 Service ports: (1) 1/4" PT
 Crack Pressure: 4 PSI
 Replaces: Bendix 065104 (R-12)
 102626 (R-12)

Part Number	Description
GTA-065104	Relay valve, vertical ports
GTA-102626	Relay valve, vertical ports

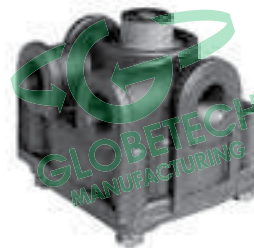

Body height: 3-7/8"
 Delivery ports: (2) 1/2" PT
 Supply ports: (2) 3/4" PT
 Service ports: (1) 1/4" PT
 Crack Pressure: 4 PSI
 Replaces: Bendix 103009 (R-12)

Part Number	Description
GTA-103009	Relay valve, horizontal ports 3/4" G port

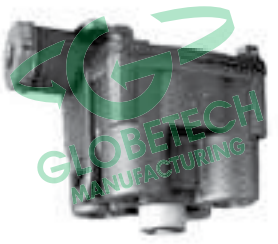

Body height: 4-7/16"
 Delivery ports: (4) 1/2" PT
 Supply ports: (1) 1/2" PT
 Service ports: (1) 1/4" PT
 Balance ports: (1) 1/8" PT - located
 beneath
 exhaust plate
 Crack Pressure: 4 PSI
 Replaces: Bendix 103028 (R-14)

Part Number	Description
GTA-103028	Relay valve, vertical ports



Body height: 4-7/16"
 Delivery ports: (2) 1/2" PT
 Supply ports: (2) 3/4" PT
 Service ports: (1) 1/4" PT
 Balance ports: (1) 1/8" PT - located
 beneath
 exhaust plate
 Crack Pressure: 4 PSI
 Replaces: Bendix 103010 (R-14)

Part Number	Description
GTA-103010	Relay valve

Air Brakes



Relay Valves

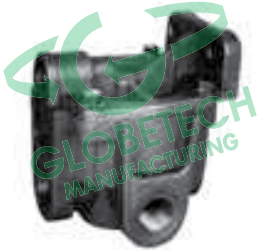

Part Number	Delivery Ports (2)	Service/Control Ports (1)	Supply/Reservoir Port (A)	Supply/Reservoir (Port (B))	Control Position	Includes Plug	Replaces Haldex#
GTA-28500	3/8"	1/4" NPT	3/8"	3/8"	90°	(1) 3/8"	KN28500
GTA-28510	3/8"		3/8"	1/2"		(1) 1/2", (1) 3/8"	KN28510
GTA-28520	1/2"		1/2"	1/2"		(1) 1/2"	KN28520

RG-2 relay valve

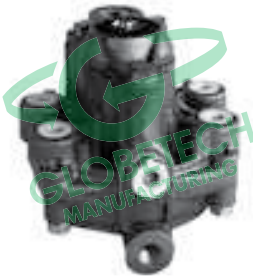

Body height: 5-5/64"
 Delivery ports: (2) 1/4" PT
 APT Delivery: (2) 3/8" PT
 Supply ports: (A) 3/4" PT
 (B) 3/8" PT
 Service ports: (1) 1/4" PT
 Emergency ports: (1) 1/4" PT
 Replaces: Bendix 281865 (RE-6)

Part Number	Description
GTA-281865	Relay valve, emergency



Service emergency relay valve (serv)
 For use on pre-121 trailers (before 1974)
 Crack Pressure: 4.5 PSI
 Replaces: Midland 12352

Part Number	Description
GTA-12352	Relay valve

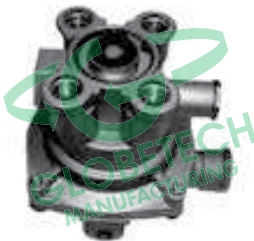

Delivery ports: (4) 3/8" NPT
 Supply ports: (1) 1/4" NPT
 Control ports: (1) GTA-110200 1/4" NPT
 GTA-110205 3/8" NPT
 Reservoir ports: (1) 3/4" NPT
 Ratio feature: yes
 Normal crack pressure: 4.5 PSI
 Replaces: Sealco 110200
 Sealco 110205

Part Number	Description
GTA-110200	Relay valve, emergency
GTA-110205	Relay valve, emergency

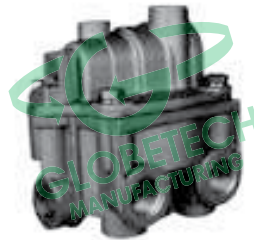

Overall height: 5-13/32"
 Delivery ports: (4) 3/8" PT
 Supply ports: (1) 1/2" PT
 Control ports: (1) 1/8" PT
 Service ports: (1) 1/4" PT
 Crack Pressure: GTA-065145 4 PSI
 GTA-065146 5.5 PSI
 Replaces: Bendix 065145 (BP-R1)
 Bendix 065146 (BP-R1)

Part Number	Description
GTA-065145	Relay valve, bobtail brake proportioning
GTA-065146	Relay valve, bobtail brake proportioning



Relay Valves

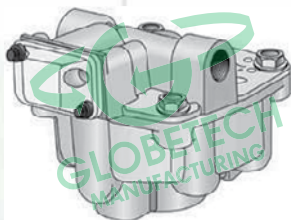

Delivery ports: (4) GTA-30300 1/4"
GTA-30400 3/4"
Reservoir ports: (1) 3/4"
Service inlet: (1) 1/4"
Emergency inlet: (1) 1/4"
Includes nipple
Crack Pressure: 3 PSI
Replaces: Haldex KN30300
KN30400

Part Number	Description
GTA-30300	Relay valve, emergency
GTA-30400	Relay valve, emergency

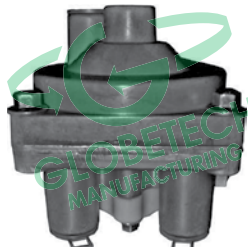

Delivery ports: (4) 3/8" NPT
Control ports: (1) 3/8" NPT
Reservoir ports: (1) 3/4" NPT
Normal crack pressure: 4 PSI
Replaces: Sealco 110415

Part Number	Description
GTA-110415	Relay valve. 4 port service

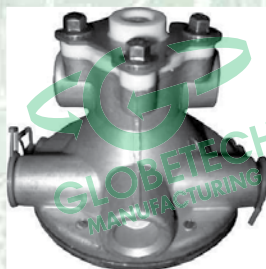

Supply port: 3/8" PT
Control port: 3/8" PT
Reservoir port A: 1/2" PT
Reservoir port B: 1/2" PT
Delivery port: 3/8"
Replaces: Sealco 110197

Part Number	Description
GTA-110197	Relay valve. 2 port service



Body height: 3-19/32"
Body width: 5-13/16"
Delivery ports: (2) 1/2" PT
Delivery ports: (1) 1/4" PT
Supply ports: (2) 3/4" PT
Service port: (1) 1/4" PT - located at 90°
Balance ports: (1) 1/8" PT - located under exhaust cover
Replaces: Bendix 286370 (R-8)

Part Number	Description
GTA-286370	Relay valve

Safety Valves Assemblies

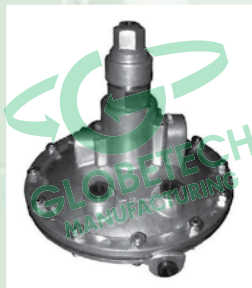

Delivery Ports: (4) 1/4" NPT
Supply Ports: (1) 1/4" NPT
Control Ports: (1) 1/4" NPT
Reservoir Ports: (1) 1/2" NPT
Normal Crack Pressure: 1.5 PSI
Replaces: Sealco A10005

Part Number	Description
GTA-A10005	Relay valve with brass, emergency



Pressure: 250 PSI
Thread: 1/2" NPT
Holes: 1
Used with Tu-Flo 550 and 750 compressor
Replaces: Bendix 131081 (ST-4)

Part Number	Description
GTA-131081	Safety valve assembly